



Crabtree, Rohrbaugh & Associates

WYOMISSING AREA SCHOOL DISTRICT

CONSTRUCTION UPDATE

July 13, 2022

WYOMISSING HILLS EC PHASING PLAN

- PHASE 1.1** JULY 2021 - AUGUST 18, 2021 PARTIAL COMPLETION
- PHASE 1.2** LAST WEEK OF NOVEMBER 2021 SUBSTANTIAL COMPLETION
- PHASE 2.1** JULY 2021 - AUGUST 18, 2021 PARTIAL COMPLETION
- PHASE 2.2** JUNE 2022 - AUGUST 2022 SUBSTANTIAL COMPLETION
- PHASE 3** AUGUST 2021 - FEBRUARY 2022
- PHASE 4** MARCH 2022 - APRIL 2022
- PHASE 5** MAY 2022 - JUNE 2022
- PHASE 6** JUNE 2022 - AUGUST 2022
- PHASE 7** JUNE 2022 - SEPTEMBER 2022

SUBSTANTIAL COMPLETION 443 CALENDAR DAYS AFTER NTP DATE.
FINAL COMPLETION 504 CALENDAR DAYS AFTER NTP DATE.



WYOMISSING HILLS CONSTRUCTION SCHEDULE

Wyomissing Hills Elementary Center

- Summer 2022: Support Spaces (including Admin, Guidance, Music, Cafeteria/Kitchen)
- Aug 2022 – Oct 2022: Final Phase Classrooms

WYOMISSING HILLS CONSTRUCTION PHOTOS



WYOMISSING HILLS CONSTRUCTION PHOTOS



WYOMISSING HILLS CONSTRUCTION PHOTOS



WYOMISSING HILLS EC PENDING CHANGE ORDERS

General Construction

- PCO 11 Gas line relocation/excavation \$41,814.30
- PCO 12 Delete new ACT in select classrooms (\$44,249.44)

Plumbing Construction

- PCO 6 Remove/install ACT for above-ceiling sprinkler work \$9,446.00
- PCO 7 Hot water service valves/connections at Kindergarten \$1,745.00
- PCO 8 Existing cmu/piping modifications for sink rough in's \$5,327.00

Electrical Construction

- PCO 15 Remove/install ACT for above-ceiling electrical work \$10,125.00

WAHS PHASING PLAN – SECOND FLOOR

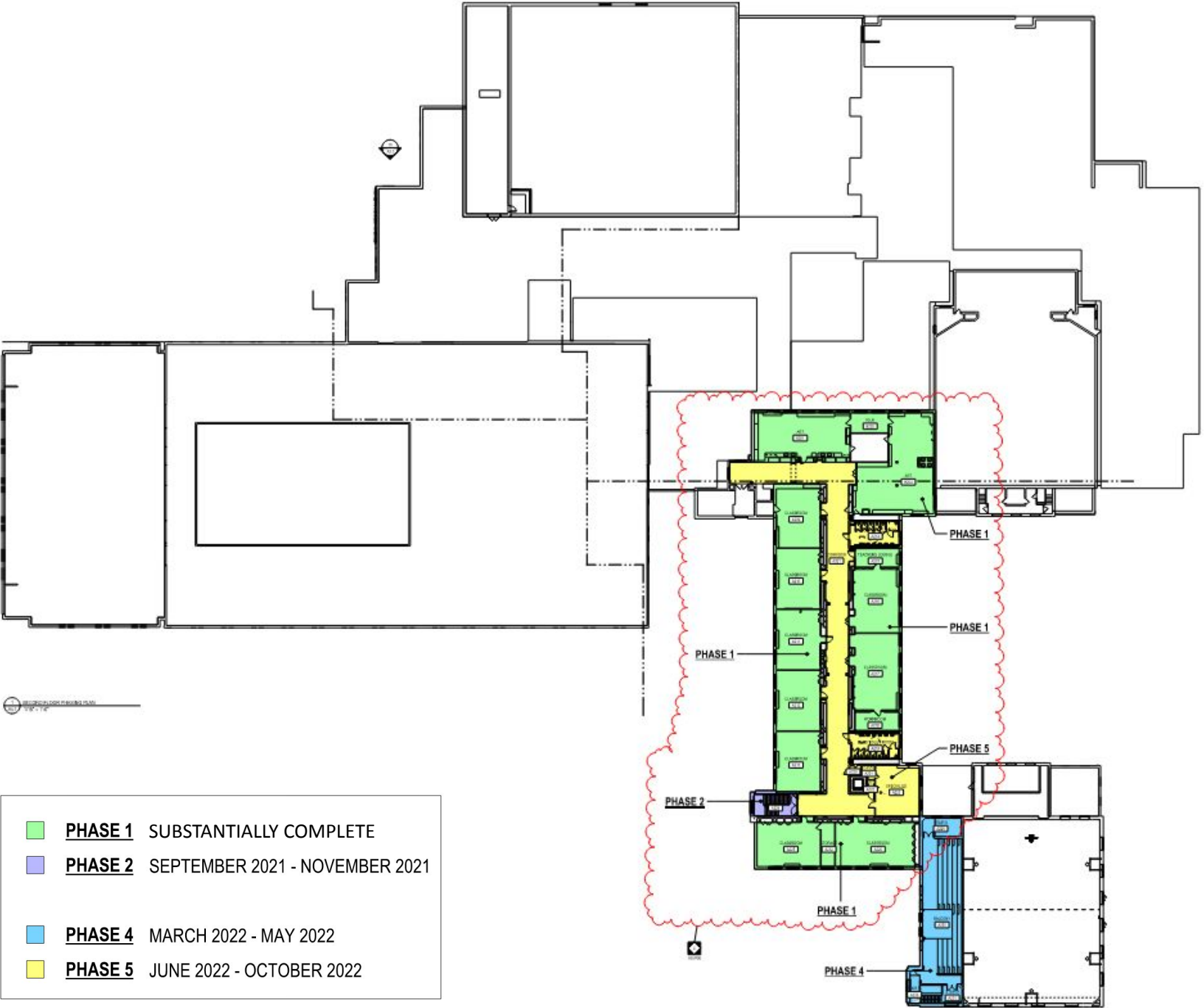

- **PHASE 1** SUBSTANTIALLY COMPLETE
- **PHASE 2** SEPTEMBER 2021 - NOVEMBER 2021
- **PHASE 4** MARCH 2022 - MAY 2022
- **PHASE 5** JUNE 2022 - OCTOBER 2022

Wyomissing Area Jr/Sr High School

- Summer 2022: Support Spaces (including Cafeteria, Media Center)
- Aug 2022 – Oct 2022 Support Spaces (including Gym/Locker Rooms, DAO Entrances)

WAHS CONSTRUCTION PHOTOS



WAHS CONSTRUCTION PHOTOS



WAHS CONSTRUCTION PHOTOS



WAHS PENDING CHANGE ORDERS

General Construction

- PCO 29 Modify gym locker base for new lockers \$10,315.42
- PCO 35 Sanitary/stormwater investigation at courtyard \$1,959.93
- PCO 37 Remove two existing oak trees in courtyard \$15,940.78
- PCO 38 Underground stormwater lines at cafeteria addition \$7,154.28
- PCO 41 Remove/dispose of existing casework in A150 & A223 \$931.77
- PCO 43 Laminate gwb over adhered ceiling in A216 & A217 \$8,082.84
- PCO 44 Add electric strike at cafeteria doors for card reader \$1,582.97
- PCO 46 Remove existing overhead grille and blackboards in Media \$1,732.90
- PCO 49 Remove/replace crushed stormwater piping at Cafeteria \$8,556.64

HVAC Construction

- PCO 16 Provide insulation @ existing ductwork at Fieldhouse \$6,309.00

WAHS PENDING CHANGE ORDERS

Plumbing Construction

- PCO 13 Replace deteriorated piping at 2nd floor toilet \$10,525.00
- PCO 14 Domestic/sanitary supply for cafeteria deli area \$15,337.00
- PCO 15 Replace existing faulty water line valves \$4,685.00
- PCO 16 Insulate existing water lines in chases \$3,128.00

Electrical Construction

- PCO 32 Misc. T&M work, incl. stage lighting, card access, fiber lines, light switch, ai phone, etc. \$6,985.03

Remaining Project Funds:

Contingency (*per Architect's Budget*)

	<u>JSHS</u>	<u>WHEC</u>	<u>WREC</u>
Budget:	\$400,000	\$450,000	\$50,000
Approved:	562,377	205,552	4,672
Proposed [^] :	<u>223,227</u>	<u>24,208</u>	<u>0</u>
Balance:	(385,604)	220,240	45,328

Total Amount Over Budget \$(120,036)

[^]includes placeholder of \$120,000 for fire alarm system

Remaining Project Funds:

Overall Budget (*per Architect's Budget*)

Bond proceeds for project:	\$25,000,000
Original budget:	23,998,028
Plus Projected CO over budget:	<u>120,036</u>
Revised Budget:	\$24,118,064
Less Budget Lines Not Needed [^] :	(526,337)
Estimated total spent on project:	\$23,591,727

[^]*Line item not needed: Financing Fees*

Construction Substantial Completion Schedule - WHEC

Cafeteria - 8/26/22

Admin Hall - 8/30/22

Classrooms - 8/26/22

Parking lot - 8/30/22

Play areas - 9/22

Construction Substantial Completion Schedule - JSHS

Media Center - 8/30/22

Cafeteria - 9/23/22

Classrooms - 8/26/22

ORIGINAL DESIGN OPTION





Providing a client oriented approach to
architecture

Questions/Discussions



Crabtree, Rohrbaugh & Associates
www.cra-architects.com